

Boundary Road

Hove



Boundary Road, Hove

£300,000 - £325,000

1

BEDROOM

1

BATHROOM

1

RECEPTION

About the property

Guide Price £300,000 - £325,000

This stunning property on the corner of a Boundary Road oozes pied-a-terre style living while mixing contemporary city life into its homey interior.

This property boasts generous space and high ceilings, which you notice immediately when entering the entrance hallway.

Flooded with natural light is the large living area to your right, yet modern with high walls and a street view. This generous space provides plenty of potential for versatile living as well as room for yourself and guests to enjoy.

A trap door allows access to a basement downstairs that the Seller has been using as a studio. This could be a second bedroom, an office space, another lounge or even something more creative. Regardless, it is hard to deny that this extra space has exciting potential that you can craft to suit your lifestyle.

The kitchen, which you can access from the living area, enjoys walled cabinets which utilise worktop space and provides storage for all your necessities.

This property boasts a generous and well-lit double bedroom that has access to the spacious garden.

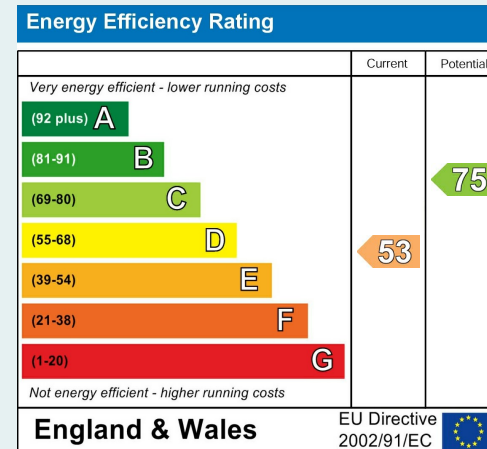

Don't miss out, call our Sales team
arrange a viewing appointment:

01273 56 77 66

174 Church Road, Hove, BN3 2DJ
hovesales@lextons.co.uk | www.lextons.co.uk



Ground Floor



Lower Ground Floor

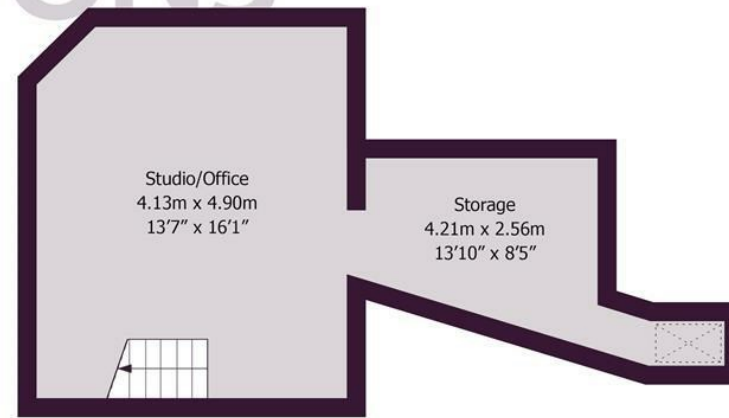

Approximate gross internal floor area 84 sq m/ 904 sq ft

Whilst every care has been taken to ensure accuracy, dimensions are approximate and for illustrative purposes only.

Created by Property Photography UK for Lextons. All rights reserved.

LEXTONS

Don't miss out, call our Sales team
arrange a viewing appointment:

01273 56 77 66

174 Church Road, Hove, BN3 2DJ
hovesales@lextons.co.uk | www.lextons.co.uk